

# Independent crushing unit GP

Models:

K15 - K25 - K50

## Technical description

An independent crushing unit that can be placed in several points of grapes reception and sorting line or directly onto the loading door of the pneumatic press in Kappa Direkt model.

It consists of two food grade rubber crushing rollers. Each roller is stamped in only one piece in order to make hygiene and cleaning operation easy. The distance between the rollers is adjustable in order to avoid seed crushing and to ensure a correct berry crushing. The combined rotation and the possibility of regulation allow the highest flexibility and quality of the product manufactured. The unit is supported by an AISI 304 stainless steel frame complete with feeding hopper.

New crushing rollers Open Grape are available, as alternative solution to the traditional crushing rollers, coated by food-grade rubber with cylindrical shape studied to enable the berry to be completely opened.

## Technical data K15 - K25 - K50

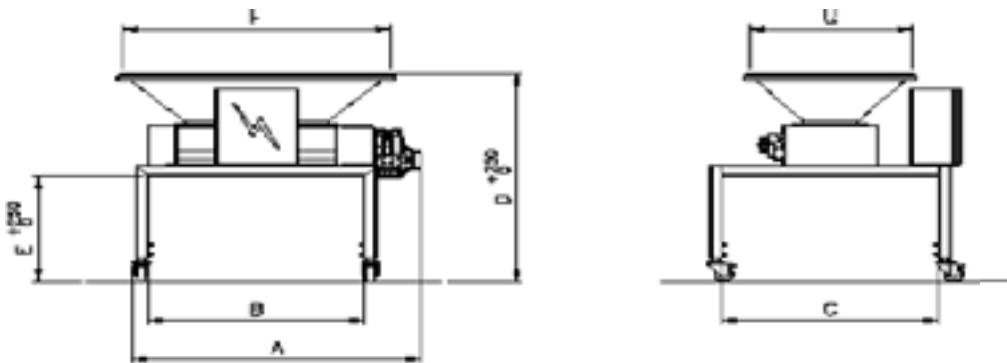

Technical data **K15 - K25 - K50**

---

		K15	K25	K50				
A	mm	988	1.238	1.398				
B	mm	860	930	1.270				
C	mm	860	930	950				
D	mm	1.057	1.080	1.355				
E	mm	520	550	623				
F	mm	701	1.151	1.148				
G	mm	695	980	1.023				
Installed power	kW	1,1	2,2	4				

**P.S.**

The above data is indicative and may vary according to the degree of ripeness, type of grape and filling method. All data refers to initial whole bunch weight prior to any operation like destemming, crushing, maceration, fermentation, etc.

